

## ④ Connect device hotspot

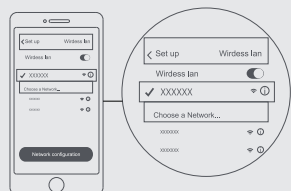

Turn on smartphone, go to "Setting-WLAN", choose "XXXXXX" network connection, when connection is done, re-open the App.



Follow what the APP indicates, choose and connect device network.

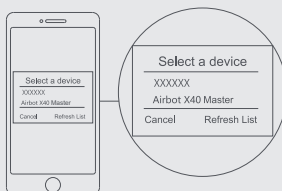

## ⑤ Network configuration

APP in network connection status, and wait for the network configuration to finish.

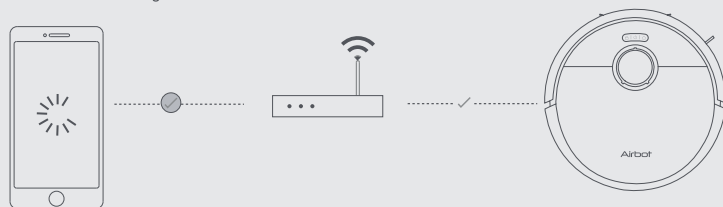

## V. Run the cleaning tasks

- ① When network configuration is done, follow the App, click "Start", to start cleaning.
- ② When the robot is on, press "⏻" to start clean.

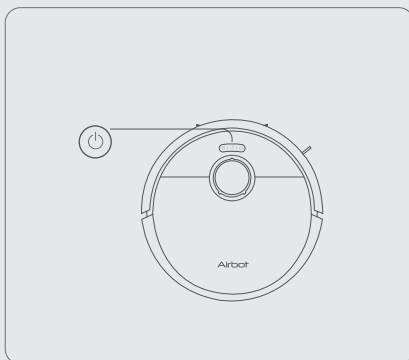
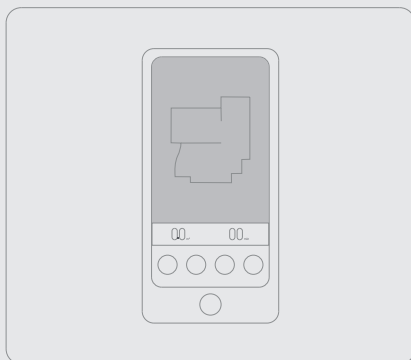

⚠ Please tidy up the wires on the floor to avoid tangling before the robot start cleaning. Do not let robot go to vacuum water.

## I. Pick below items from the package

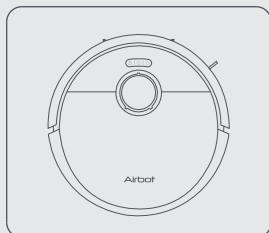

Robot\*1

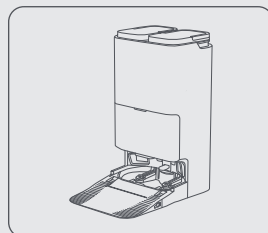

Base Station\*1

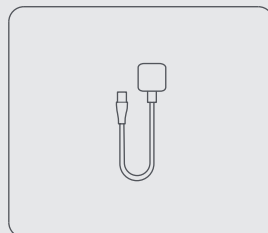

Power Cord \*1

## II. Connect the charging base to the power

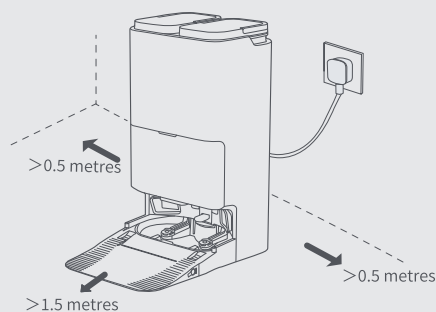

### Tips:

- Do not place the base station in direct sunlight.
- Make sure there is more than 1.5 meters in front of the base station and more than 0.5 meters on both sides.
- Be careful to put away the power cord, otherwise it may be dragged by the sweeping and mopping robot, causing the base station to move or power outage.
- The clean water tank, sewage tank, and dust bag must be installed in place.
- To ensure the sterilization effect of electrolyzed water, please add municipal tap water to the clean water tank, and do not use purified water.

## III. Start-up preparation

When using for the first time, press and hold the "⏻" button for 3 seconds to turn on the device. After turning on the device, manually place the main unit against the base station and align the charging pole with the charging spring. In daily use, you can directly press "🏠" to start smart recharging.

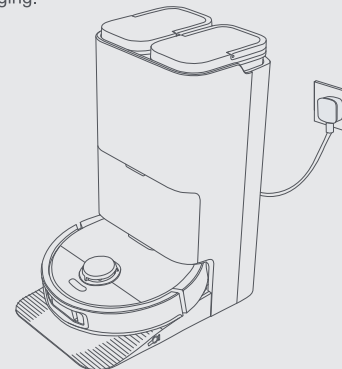

### Indicator status description

White steady light	Normal
Yellow flashing	Abnormal

## IV. Download the App and configure network

① Scan the QR code below to download the APP.



② Hold down the "⏻"+"+" button for 3 seconds to enter the network configuration mode.

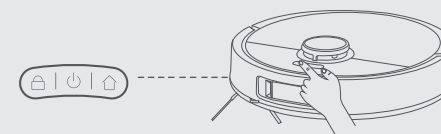

③ Enter WiFi password

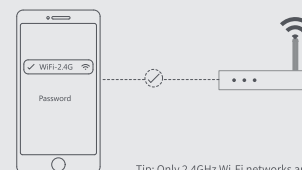

Tip: Only 2.4GHz Wi-Fi networks are supported.

\* Remark: The robot does not support WiFi networks at 5G frequency band